

WOOD DESTROYING PESTS AND ORGANISMS INSPECTION REPORT

Building No. 2270	Street EAST SMOKEWOOD AVENUE	City PALM SPRINGS	ZIP 92264	Date of Inspection 05/02/2024	Number of Pages 4
----------------------	---------------------------------------	----------------------	--------------	----------------------------------	----------------------



Mr. Beez Termite and Pest Control, Inc.

P.O. Box 460
Palm Springs CA 92263
(760) 774-9112 (760) 992-0724
Mrbeezpestcontrol1@gmail.com

Report # : 12811

Registration # : PR8603

Escrow # :

☐ CORRECTED REPORT

Ordered by: MARCUS MICELI INITIATE REALTY 2350 N LOS ALAMOS ROAD PALM SPRINGS CA 92262 United States	Property Owner and/or Party of Interest:	Report sent to:
---	--	-----------------

COMPLETE REPORT <input checked="" type="checkbox"/>	LIMITED REPORT <input type="checkbox"/>	SUPPLEMENTAL REPORT <input type="checkbox"/>	REINSPECTION REPORT <input type="checkbox"/>
---	---	--	--

GENERAL DESCRIPTION: One-story single family residence, stucco, shingle roof, vacant, attached garage	Inspection Tag Posted: Garage
	Other Tags Posted:

An inspection has been made of the structure(s) shown on the diagram in accordance with the Structural Pest Control Act. Detached porches, detached steps, detached decks and any other structures not on the diagram were not inspected.

Subterranean Termites <input type="checkbox"/>	Drywood Termites <input type="checkbox"/>	Fungus / Dryrot <input type="checkbox"/>	Other Findings <input checked="" type="checkbox"/>	Further Inspection <input type="checkbox"/>
--	---	--	--	---

If any of the above boxes are checked, it indicates that there were visible problems in accessible areas. Read the report for details on checked items.

Diagram Not To Scale

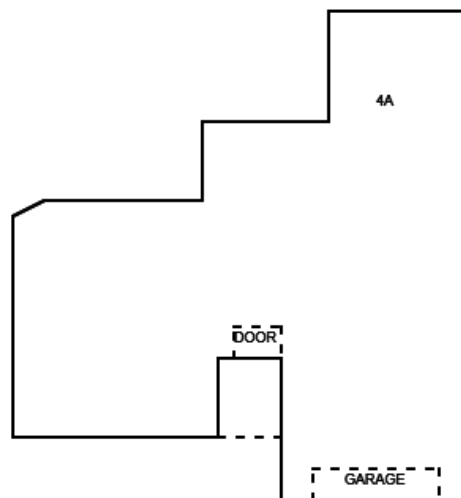

Inspected By: Anthony Pagliari	State License No. FR58979	Signature:
---------------------------------------	----------------------------------	------------

You are entitled to obtain copies of all reports and completion notices on this property reported to the Structural Pest Control Board during the preceding two years. To obtain copies contact: Structural Pest Control Board, 2005 Evergreen Street, Suite 1500, Sacramento, California, 95815-3831.

NOTE: Questions or problems concerning the above report should be directed to the manager of the company. Unresolved questions or problems with services performed may be directed to the Structural Pest Control Board at (916) 561-8708, (800) 737-8188 or www.pestboard.ca.gov.

43M-41 (Rev. 04/2015)

MR. BEEZ TERMITE AND PEST CONTROL, INC.

Page 2 of 4 inspection report

2270	EAST SMOKEWOOD AVENUE	PALM SPRINGS	CA	92264
Address of Property Inspected		City	State	ZIP
05/02/2024	12811			
Date of Inspection	Corresponding Report No.	Escrow No.		

****HOME IS CLEAR OF SECTION 1, FINDINGS SECTION 2****

WHAT IS A WOOD DESTROYING PEST & ORGANISM INSPECTION REPORT? READ THIS DOCUMENT. IT EXPLAINS THE SCOPE AND LIMITATIONS OF A STRUCTURAL PEST CONTROL INSPECTION AND A WOOD DESTROYING PEST & ORGANISM INSPECTION REPORT.

A Wood Destroying Pest & Organism Inspection Report contains findings as to the presence or absence of evidence of wood destroying pests and organisms in visible and accessible areas and contains recommendations for correcting any infestations or infections found. The contents of Wood Destroying Pest & Organism Inspection Reports are governed by the Structural Pest Control Act and regulations.

Some structures do not comply with building code requirements or may have structural, plumbing, electrical, mechanical, heating, air conditioning or other defects that do not pertain to wood destroying organisms. A Wood Destroying Pest & Organism Inspection Report does not contain information on such defects, if any, as they are not within the scope of the licenses of either this company, or it's employees.

The Structural Pest Control Act requires inspection of only those areas which are visible and accessible at the time of inspection. Some areas of the structure are not accessible to inspection, such as the interior of hollow walls, spaces between floors, areas concealed by carpeting, appliances, furniture or cabinets. Infestations or infections may be active in these areas without visible and accessible evidence. If you desire information about areas that were not inspected, a further inspection may be performed at an additional cost. Carpets, furniture or appliances are not moved and windows are not opened during a routine inspection.

The exterior Surface of the roof was not inspected. If you want the water tightness of the roof determined, you should contact a roofing contractor who is licensed by the Contractor's State License Board.

This company does not certify or guarantee against any leakage, such as (but not limited to) plumbing, appliances, walls, doors, windows, any type of seepage, roof or deck coverings. This company renders no guarantee, whatsoever, against any infection, infestation or any other adverse condition which may exist in such areas or may become visibly evident in such area after this date. Upon request, further inspection of these areas would be performed at an additional charge.

In the event damage or infestation described herein is later found to extend further than anticipated, our bid will not include such repairs. OWNER SHOULD BE AWARE OF THIS CLOSED BID WHEN CONTRACTING WITH OTHERS OR UNDERTAKING THE WORK HIMSELF/HERSELF.

If requested by the person ordering this report, a re-inspection of the structure will be performed. Such requests must be within four (4) months of the date of this inspection. Every re-inspection fee amount shall not exceed the original inspection fee.

Wall paper, stain, or interior painting are excluded from our contract. New wood exposed to the weather will be prime painted, only upon request at an additional expense.

This company will reinspect repairs done by others within four months of the original inspection. A charge, if any, can be no greater than the original inspection fee for each reinspection. The reinspection must be done within ten (10) working days of request. The reinspection is a visual inspection and if inspection of concealed areas is desired, inspection of work in progress will be necessary. Any guarantees must be received from parties performing repairs.

NOTICE: Reports on this structure prepared by various registered companies should list the same findings (i.e. termite infestations, termite damage, fungus damage, etc.). However, recommendations to correct these findings may vary from company to company. You have a right to seek a second opinion from another company.

This Wood Destroying Pest & Organisms Report DOES NOT INCLUDE MOLD or any mold like conditions. No reference will be

MR. BEEZ TERMITE AND PEST CONTROL, INC.

Page 3 of 4 inspection report

2270	EAST SMOKEWOOD AVENUE	PALM SPRINGS	CA	92264
Address of Property Inspected		City	State	ZIP
05/02/2024	12811			
Date of Inspection	Corresponding Report No.		Escrow No.	

made to mold or mold-like conditions. Mold is not a Wood Destroying Organism and is outside the scope of this report as defined by the Structural Pest Control Act. If you wish your property to be inspected for mold or mold like conditions, please contact the appropriate mold professional.

MR. BEEZ TERMITE AND PEST CONTROL, INC.

Page 4 of 4 inspection report

2270 EAST SMOKEWOOD AVENUE

PALM SPRINGS

CA

92264

Address of Property Inspected

City

State

ZIP

05/02/2024

12811

Date of Inspection

Corresponding Report No.

Escrow No.

THIS IS A SEPARATED REPORT WHICH IS DEFINED AS SECTION I/SECTION II CONDITIONS EVIDENT ON THE DATE OF THE INSPECTION.

SECTION I CONTAINS ITEMS WHERE THERE IS EVIDENCE OF ACTIVE INFESTATION, INFECTION OR CONDITIONS THAT HAVE RESULTED IN OR FROM INFESTATION OR INFECTION.

SECTION II ITEMS ARE CONDITIONS DEEMED LIKELY TO LEAD TO INFESTATION OR INFECTION BUT WHERE NO VISIBLE EVIDENCE OF SUCH WAS FOUND.

FURTHER INSPECTION ITEMS ARE DEFINED AS RECOMMENDATIONS TO INSPECT AREA(S) WHICH DURING THE ORIGINAL INSPECTION DID NOT ALLOW THE INSPECTOR ACCESS TO COMPLETE HIS INSPECTION AND CANNOT BE DEFINED AS SECTION I OR II.

SECTION II:

4A - Other Findings

FINDING - Evidence of water stain found on finished ceiling in master bedroom as noted on diagram as 4A. Dry at time of inspection.

RECOMMENDATION - call licensed contractor for further inspection

Thank you for selecting us to perform a structural pest control inspection on your property. Should you have any questions regarding this report, please call us directly by the contact information provided on the first page of the inspection report.

Our inspectors have determined that your property will benefit from a safe application of chemicals commonly used for structural pest control. In accordance with the laws and regulations of the State of California, we are required to provide you and your occupants with the following information prior to any application of chemicals to such property.

Please take a few moments to read and become familiar with the content. State law requires that you be given the following information:

CAUTION - PESTICIDES ARE TOXIC CHEMICALS. Structural pest control companies are registered and regulated by the Structural Pest Control Board, and apply pesticides which are registered and approved for use by the California Department of Pesticide Regulation and the United States Environmental Protection Agency. Registration is granted when the state finds that based on scientific evidence, there are no appreciable risks weighted by the benefits. The degree of risk depends on the degree of exposure, so exposure should be minimized.

If within 24 hours following application, you experience symptoms similar to common seasonal illness comparable to the flu, contact your physician or poison control center and your pest control operator immediately.

For further information, contact any of the following agencies in your area:

Poison Control Center
Agricultural Department
Health Department
Structural Pest Control Board

(800) 222-1222
(951) 955-3045
(951) 358-5058
(916) 561-8700
2005 Evergreen Street, Ste. 1500. Sacramento, CA 95815



INVOICE / STATEMENT

Mr. Beez Termite and Pest Control, Inc.

P.O. Box 460
Palm Springs CA 92263
(760) 774-9112 (760) 992-0724
Mrbeezpestcontrol1@gmail.com

Date: 05/02/2024

Report Number: 12811

Invoice Number: 12811-1

Escrow Number:

Property 2270 EAST SMOKEWOOD AVENUE
Inspected: PALM SPRINGS, CA 92264

Bill To: MARCUS MICELI
INITIATE REALTY
2350 N LOS ALAMOS ROAD
PALM SPRINGS, CA 92262
United States

MOBILE: (310) 741-8342
marcus@initiaterealty.com

Inspection: \$	120.00
Invoice Total: \$	120.00
Payments: \$	120.00
Total Due: \$	0.00

Description of Service

RETAIN THIS COPY FOR YOUR RECORDS

THANK YOU FOR YOUR BUSINESS

CUT HERE

CUT HERE

CUT HERE



INVOICE / STATEMENT

Mr. Beez Termite and Pest Control, Inc.

P.O. Box 460
Palm Springs CA 92263
(760) 774-9112 (760) 992-0724
Mrbeezpestcontrol1@gmail.com

Date: 05/02/2024

Report Number: 12811

Invoice Number: 12811-1

Escrow Number:

Property 2270 EAST SMOKEWOOD AVENUE
Inspected: PALM SPRINGS, CA 92264

Bill To: MARCUS MICELI
INITIATE REALTY
2350 N LOS ALAMOS ROAD
PALM SPRINGS, CA 92262
United States

MOBILE: (310) 741-8342
marcus@initiaterealty.com

Inspection: \$	120.00
Invoice Total: \$	120.00
Payments: \$	120.00
Total Due: \$	0.00

Description of Service

RETURN THIS COPY WITH REMITTANCE

THANK YOU FOR YOUR BUSINESS